

Kettering New Hospital Programme

Background

- KGH announced in Oct 19 for two funding pots which we later agreed could be merged:
 - STP wave 4b - £49m for a new A&E (requested via an OBC)
 - HIP2 - £350m (
- Early 2020 started a Masterplan and DCP for the site via a SOC – submitted end 2020.
- Ruled out a greenfield whole new hospital – too expensive and subject to delays
- OBC (RIBA stage 2 designs) submitted to NHSE July 2022 for PWF - £585m
 - No land acquisition or public consultation required
 - Local planning support in place; main scheme pre-app and LDO for enabling works
 - Can be delivered in defined phases of construction works and decant/demolition
 - Large opportunities for incorporating standard designs across theatres, wards and critical care
- Consistently recognised by NHP and Ministers as an ‘easy scheme’, suitable for regular annual slippage
- Energy Infrastructure known as high risk and key enabler so further short form business case submitted for £38m – approved by HMT to progress to FBC in October 22 – funding only received February 23

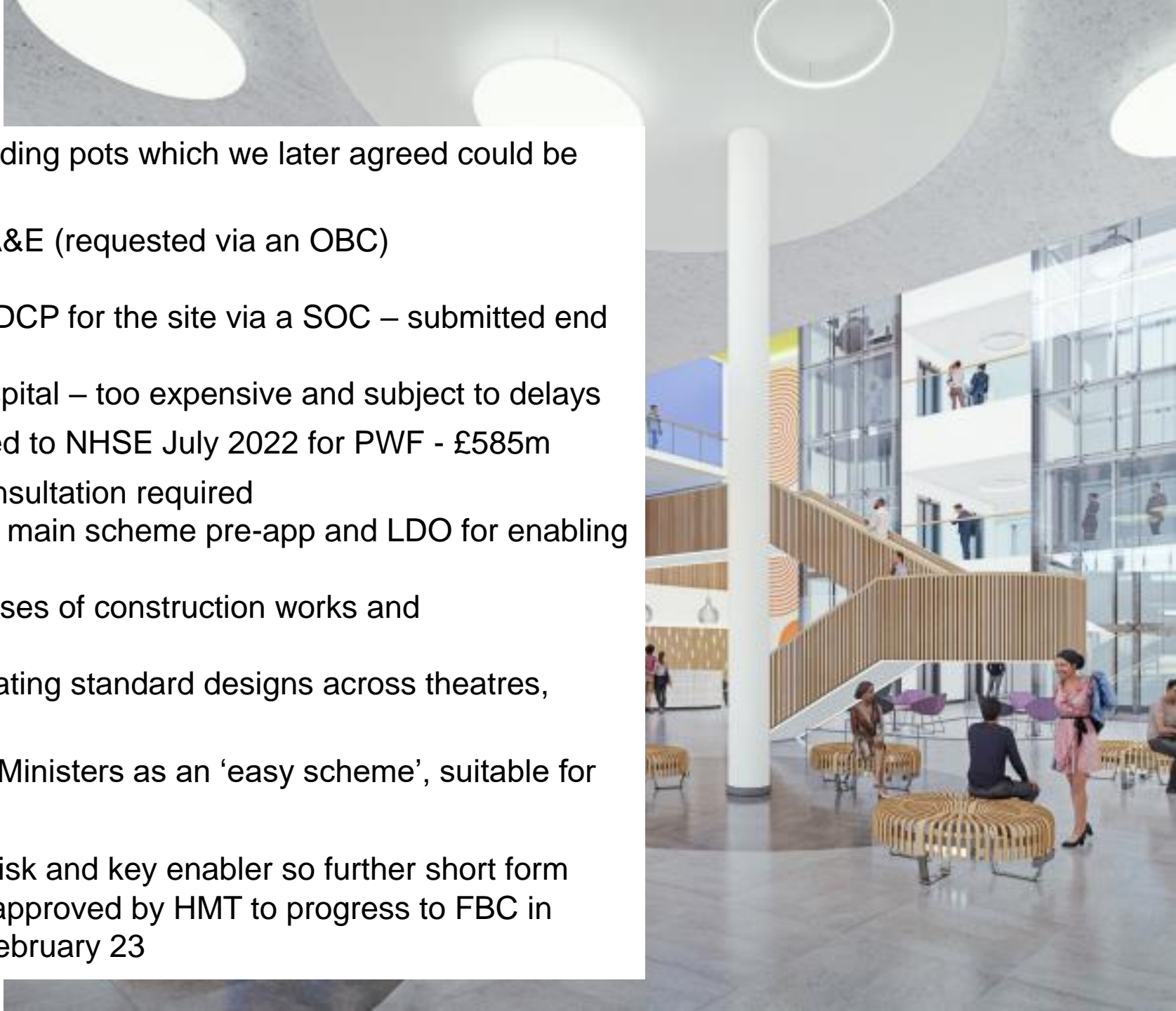

An overview of the Kettering Scheme

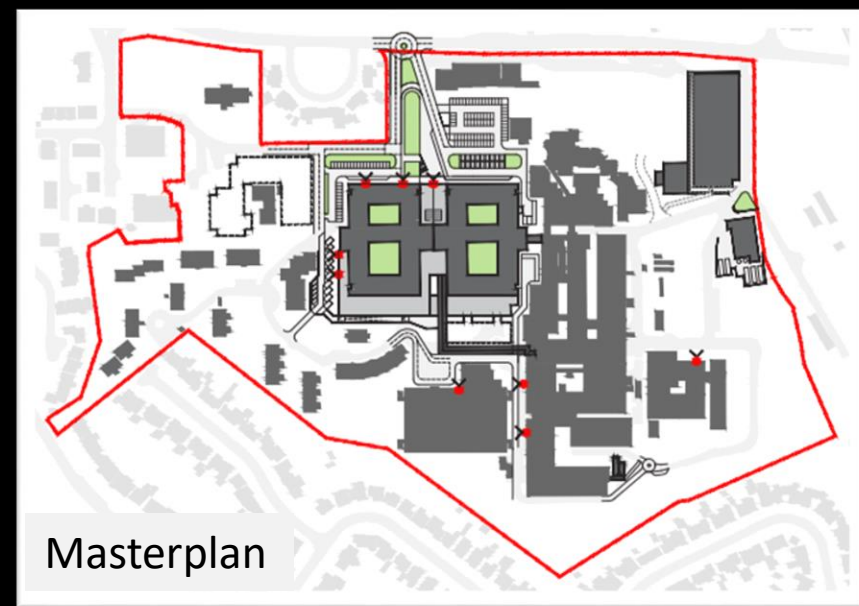
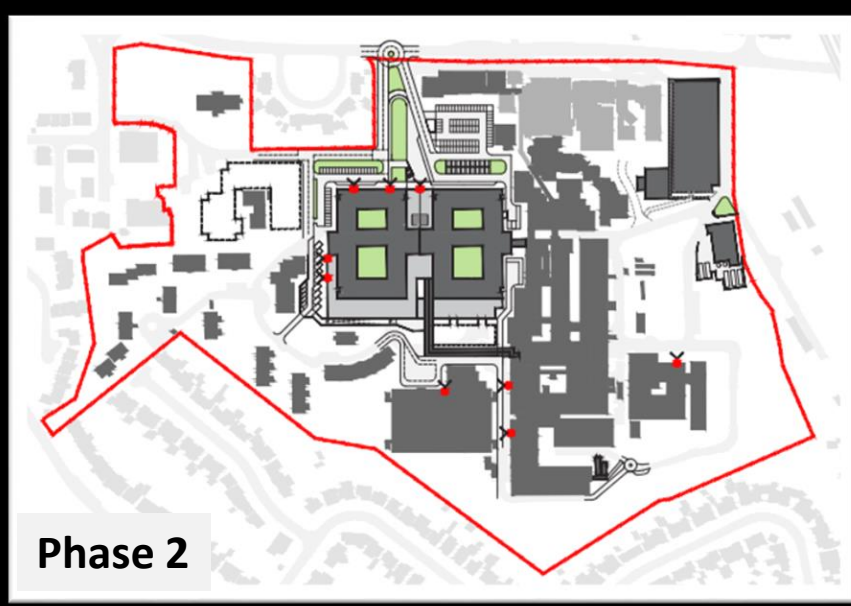
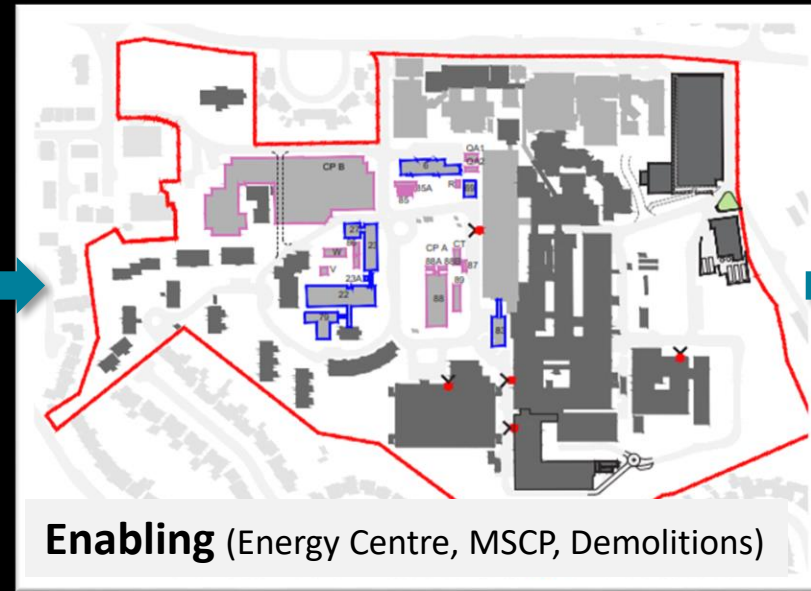

What will be included in the new hospital?

Phase 1

- Adult and Child Emergency Department
- Short Stay Paediatric Assessment Unit
- ED Imaging (also inpatient out of hours)
- Elderly Frailty Unit & Emergency Decisions Unit
- Medical SDEC and Medical Assessment Unit
- Surgical SDEC and Surgical Decisions Unit
- 5 Generic Inpatient Wards
- Mortuary

Phase 2

- Main Entrance
- Endoscopy Unit
- Orthopaedics and Fracture Clinic
- Diagnostic Imaging Department
- 6 Operating Theatres and Recovery Suite
- 20 bed Critical Care Unit
- 6 Generic Inpatient Wards
- FM Service Hub



Where are we now...

- **Energy Infrastructure**

- Construction partner now in place and stage 3 designs complete.
- £49m investment approved in principle with FBC due June 24
- But....work on electrical intake to begin Feb 24

- **Other key enablers – approvals expected later in 2024**

- Multi-Storey carpark
- Moving some services and office staff
- Demolition of corporate buildings

- **Main Scheme:**

- Demand and capacity modelling/check
- Organisational Readiness assessment
- Clinical re-prioritisation incl.mortuary, womens and childrens
- Working within the national approach to design, procurement, funding envelopes etc.
- Internal Transformation – Digital, Ways of working etc
- Interim carparking and wayfinding
- Earliest build start 2026

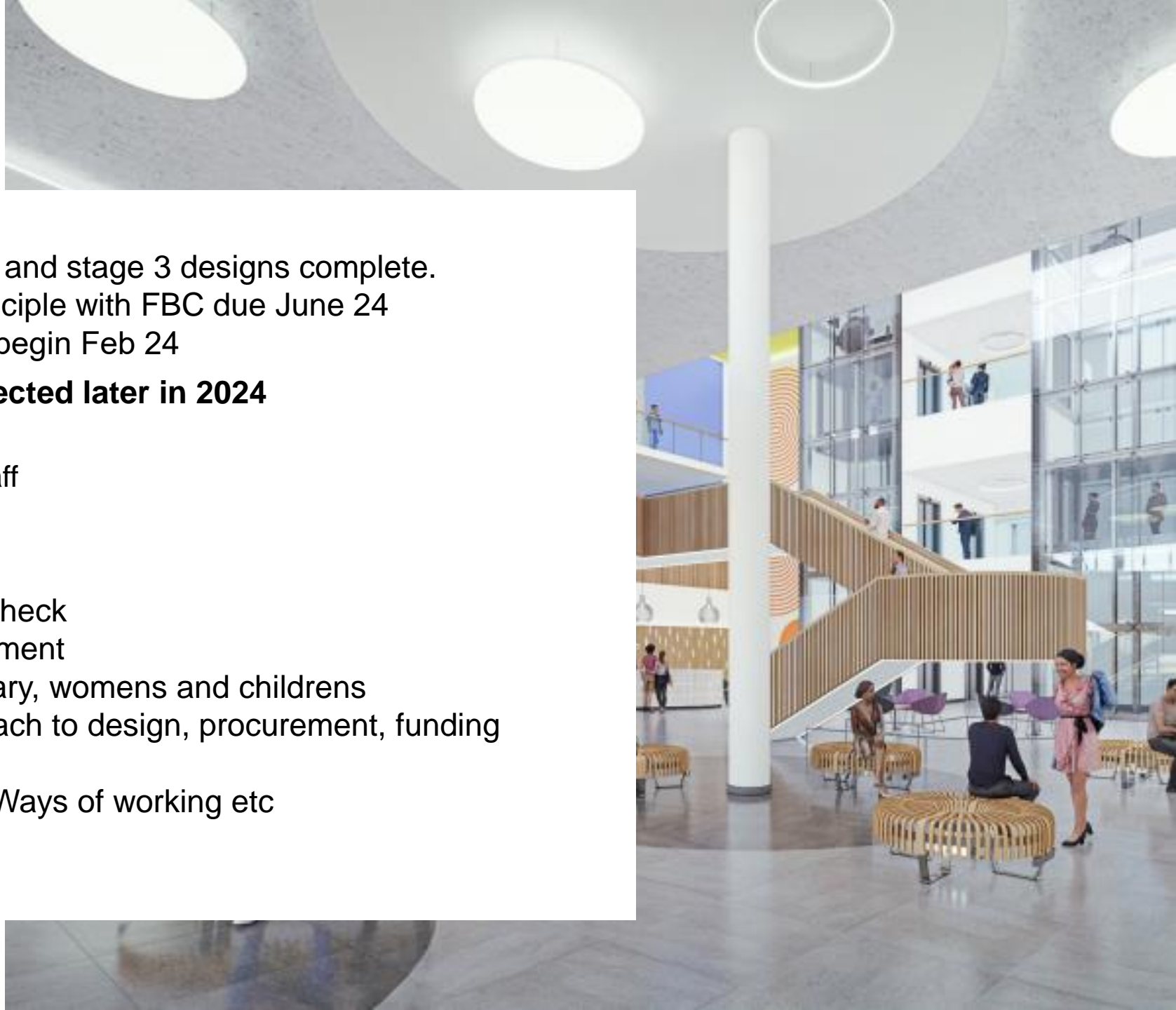

High Level Timeline

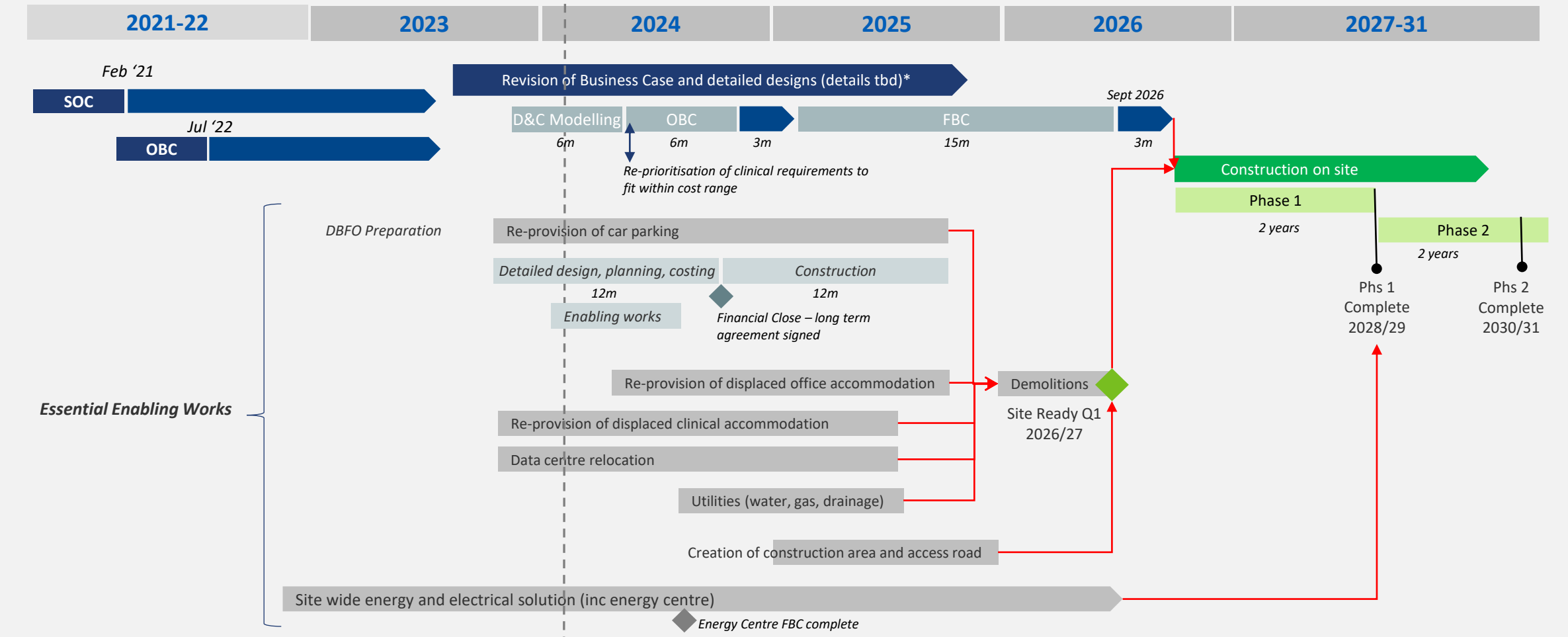

* Timeframe for business case revisions and approvals subject to NHP informing scheme of process and requirements.

Essential Enabling Works:

Single stage cases being prepared with expected completion Jan '24

Proposed 3D Massing

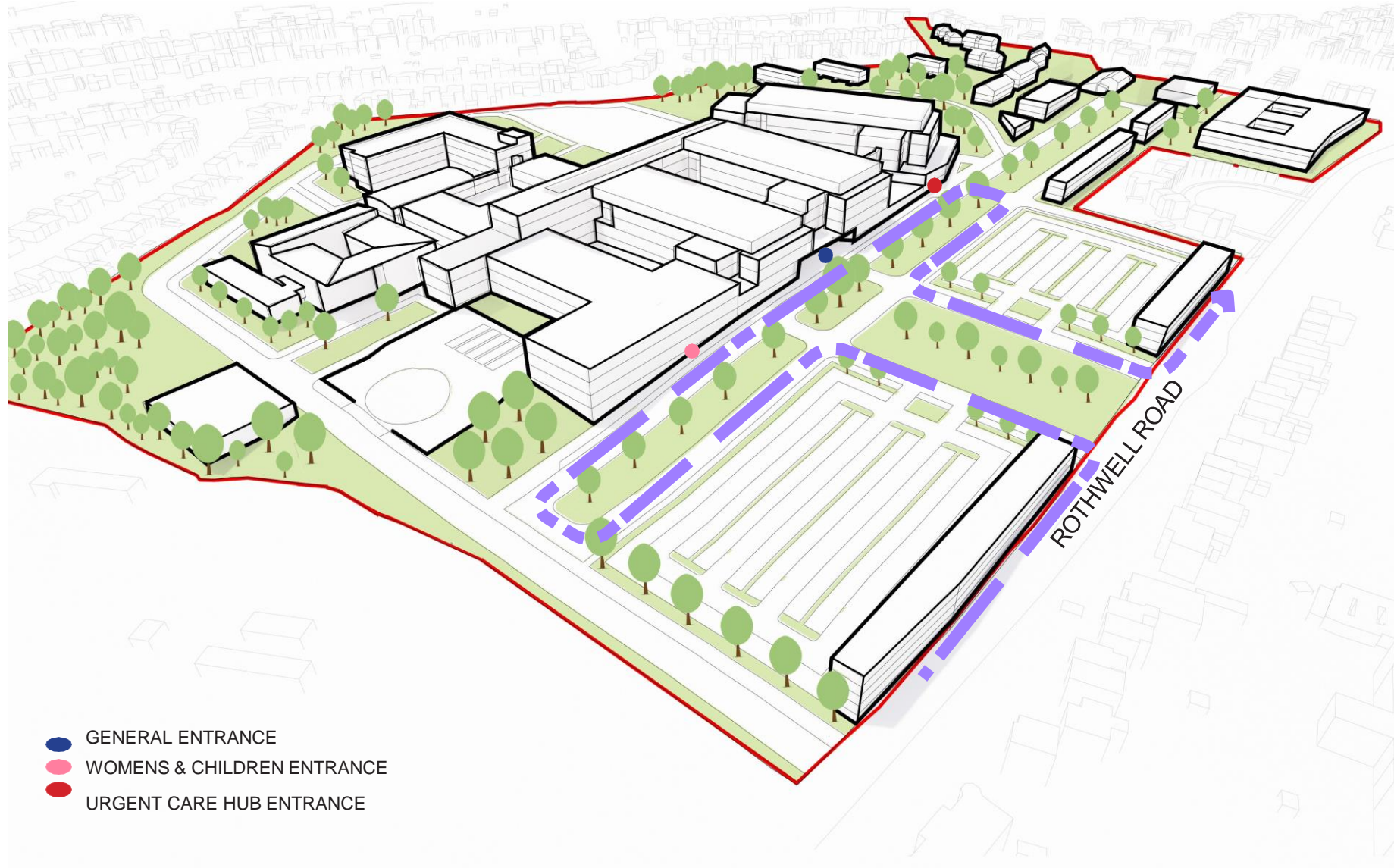

6-Month Timeline

